

Second Wave

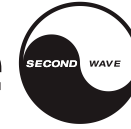

Pedestal 30

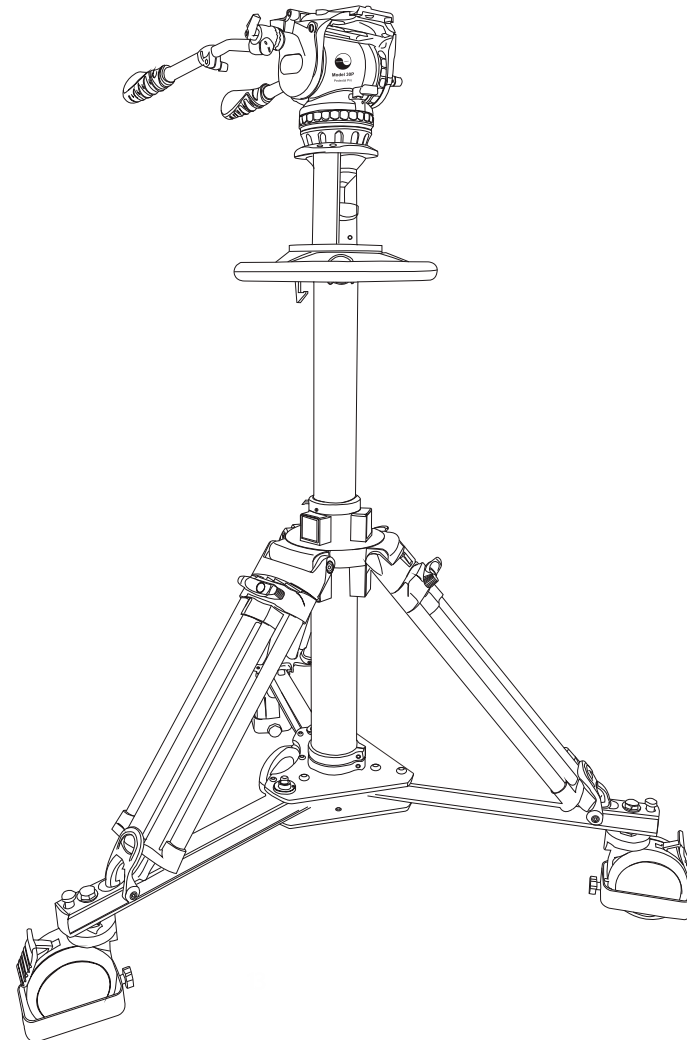

+49 - 160 2160395

punkt@schnittpunkt.de

SCHNITTPUNKT UG (haftungsbeschränkt)

Im Lampental 24

56598 Rheinbrohl

www.schnittpunkt.eu

Contents

Warning	2
Safety Notes	2
A Part Diagram	3
B Setting Up Of The Pedestal	5
C Mounting The Head	6
D Air Pump Operation	7
E Air Release Valve	8
F Safety Lock Operation	9
G Setting Up The Extension Column	10

Warning

Please read this manual completely before using the EP880XF / EP880XFK pedestal. Improper use could damage the equipment and/or lead to personal injury. This manual contains important information for proper equipment use and precautions to avoid personal injury.

Familiarize yourself with this manual and keep it handy for easy reference while pedestal is in use.

For your safety, follow all of the precautions and instructions listed below.

Safety Notes

- ▲ Failure to follow these precautions can result in personal injury.
- ▲ Keep your upper body away from the upper column while pumping air.
- ▲ If the air pressure exceeds necessary levels for the camera weight the column may quickly rise and cause injury or equipment damage.
- ▲ Engage the safety lock when removing your camera. Center column may rise quickly when the camera is removed.
- ▲ Do not exceed the load capacity of the pedestal or video head. Overloading the pedestal could result in spontaneous collapse or failure of equipment locks.
- ▲ Do not dismantle or remove any parts of the pedestal that are not designed to be removed. This may result in the warranty being voided, equipment damage, or personal injury.
- ▲ Check all safety equipment locks for tightness and effectiveness. If locks are not effectively tightened, equipment may slip or fall off, causing personal harm or damage to equipment.
- ▲ Engage all safety locks when storing or transporting the pedestal.
- ▲ Check the air pressure before using the pedestal. Air pressure can change while in transport, while being stored, or when there is a change in temperature. The relief valve can handle some changes, but the operator should always check the air pressure gauge before use.
- ▲ It is recommended to remove air completely during transport or long periods of storage.

A Pedestal 30

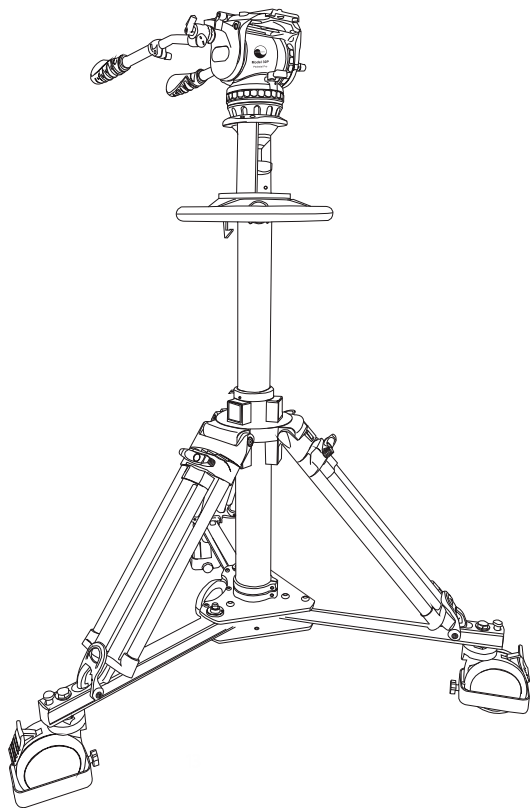

Model	Pedestal 30
Max.Height range	182.5cm / 71.9in
Min.Height range	103.5cm / 40.7in
One-shot stroke	38.0cm / 15.0in
Payload range	30.0kg / 66.0lbs
Net weight	28.8kg / 63.4lbs
Component	
Head	Model 30P
Pedestal	Pedestal 30
Dolly	Pedestal 30 dolly
Packing	Head(Box Packing) Pedestal (Box Packing) Dolly (Box Packing)

A Pedestal 30

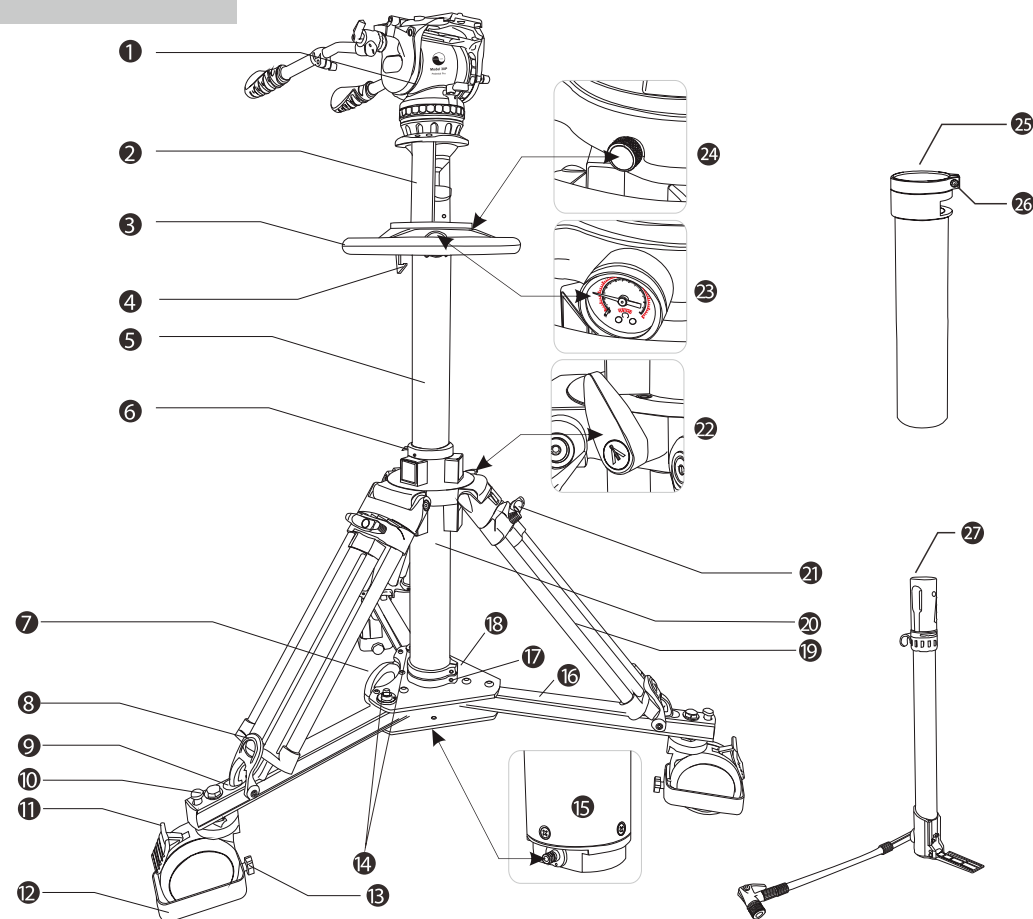

- 1. Head
- 2. Head Bowl
- 3. Grip Wheel
- 4. Safety Lock
- 5. Upper Column
- 6. Column Safety Latch
- 7. Dolly
- 8. Rubber Foot Hook
- 9. Rubber Foot Hook Groove
- 10. Dolly Wheel Angle Lock
- 11. Dolly Wheel Lock
- 12. Cable Guard
- 13. Cable Guard Height Lock
- 14. Dolly Leg Locking Button
- 15. Air Inlet
- 16. Dolly Leg
- 17. Lower Column Lock Knob
- 18. Column Stopper
- 19. Pedestal Leg
- 20. Lower Column
- 21. Leg Lock Knob
- 22. Upper Column Lock Knob
- 23. Air Pressure Gauge
- 24. Air Pressure Bleed Valve
- 25. Extension Column
- 26. Extension Column Locking Screw
- 27. Air Pump

B

B-1

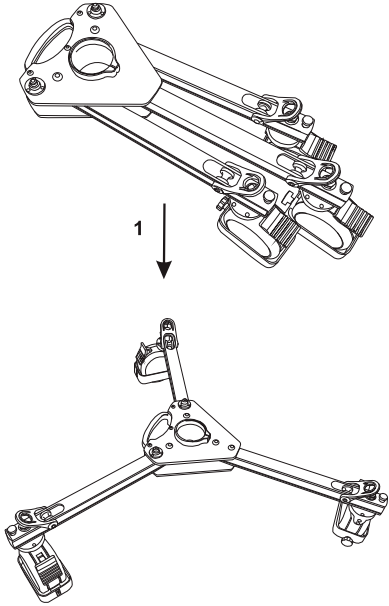

B-2

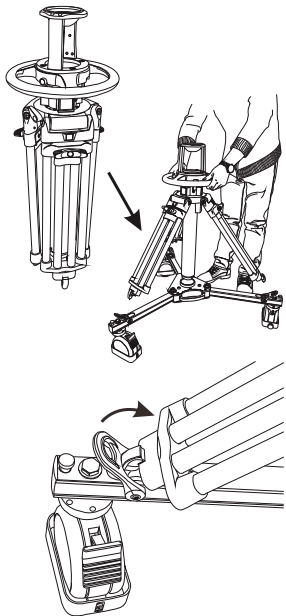

B: Setting up of the Pedestal

B-1: Setting up of the dolly

1. Take out the dolly from box, spread the side two legs until location buttons fall down.

B-2: Setting Pedestal on the dolly

2. Take out the pedestal from the box.
3. Spread the three legs.
4. Insert the 3 spike feet into the slot of the dolly. Pull the leg band to hang over the tripod leg by the hook to secure the foot over the spikes.

C

C: Mounting the Head

Put the head on the Head bowl, secure the locking knob after adjusting the head into level according to same way as putting head on the tripod. Then put the camera on the head in the same way as camera is usually mounted on the head.

1. The head bowl allows 100mm bowl heads.
2. Refer to the instructions of the head for adjusting the leveling and mounting the camera.

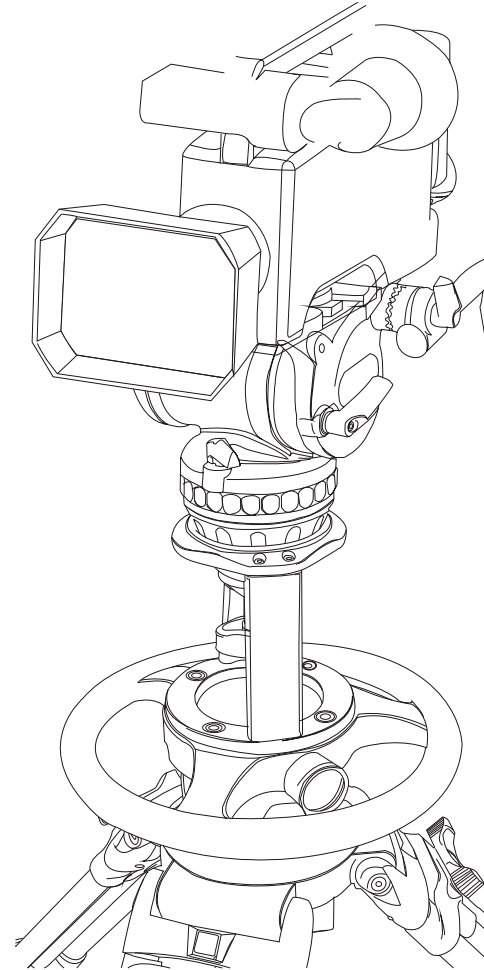

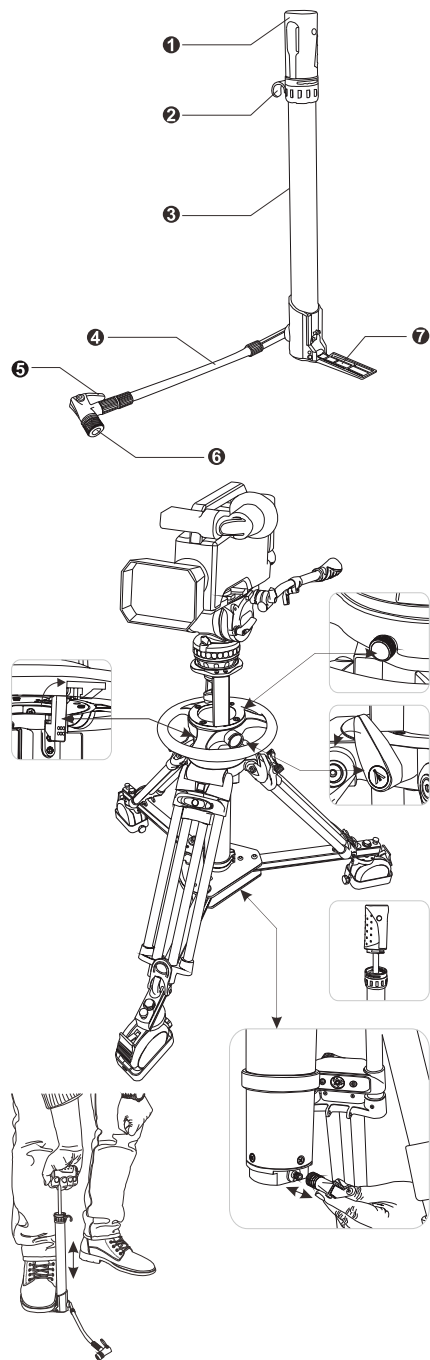

D: Air Pump Operation

D-1: Air Pump Parts

1. Handle
2. Hose Hanger
3. Cylinder
4. Hose
5. Nozzle Lock
6. Nozzle
7. Pump Feet

D-2: Air Pump Operation

- Fully insert pump nozzle into air inlet.
- Engage the nozzle lock lever and ensure the nozzle is secure.
- Close the pedestal bleed valve and release the column lock and safety catch.
- With the camera mounted on the pedestal, place the pump on stable ground and pump air into the column.
- Continue adding air until the pedestal is at the required level. Use the bleed valve to release air if too much is added.
- Unlock the pump nozzle and remove it from the air inlet.

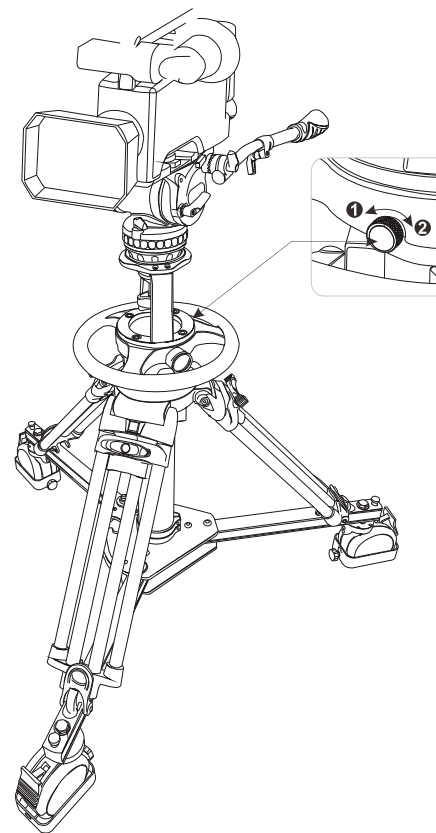

E: Air Release Valve

It may become necessary to release air from the center column in certain circumstances like over-filling, storing, transport, and temperature changes. To release air:

1. Loosen the air release valve and air will begin to exit the column. The looser the valve, the faster the air leaves.
2. When enough air is out, tighten the valve until it is completely shut.

Attention:

- Air may leak from the valve if it is not completely tightened.
- DO NOT attempt to add air to the column through the air release valve.
- Make sure the column is lowered and locked before releasing air. Column may fall and cause damage or personal injury if it is not secured.

F: Safety Lock Operation

F-1: Engaging the Safety Lock

1. Hold the grip wheel and use your body weight to push the center column down as far as it will go.
2. Visually check the safety latch to make sure it has properly locked, and slowly reduce weight on the center column until locking is confirmed.

F-2: Releasing the Safety Lock

1. Hold the grip wheel and use your body weight to push down on the center column.
2. Release the safety latch and slowly allow the column to rise.

Attention

- If air is still stored in the center column, the upper column may rise quickly and cause damage or personal injury. Make sure to keep weight on the column and allow it to rise slowly.
- DO NOT release the grip wheel until you are sure the column has risen as far as it can with the amount of air present in the column.

G: Column Height Adjustment

1. Unlock the upper column lock knob and release the column safety lock.
2. Adjust the upper column to the required height. Add air if it is too low, and release air if it is too high.
3. Lock the column lock knob.

Attention

It is best practice to adjust column height while the camera is mounted on the pedestal.

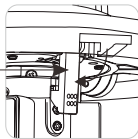
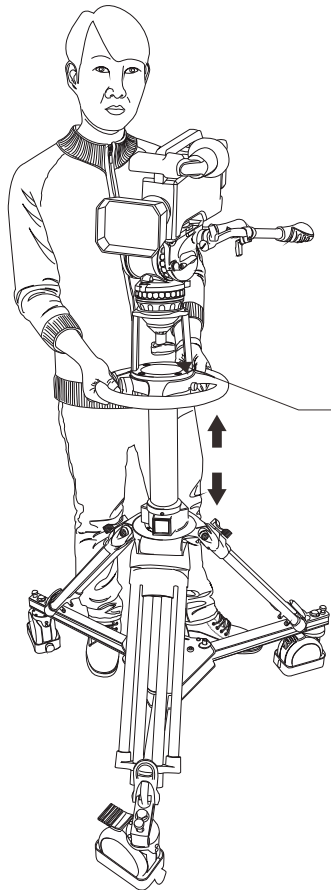

G: Setting Up the Extension Column

An extension column is included with the pedestal to securely add extra height to the pedestal.

1. Loosen the screw on the column stopper and slide the column stopper off of the lower column.
2. Install the column stopper on the bottom of the extension column.
3. Place the extension column into the central hole of the dolly until it stops at the column stopper.
4. Unlock the pedestal legs, and extend them fully, then locks the legs and attach the pedestal to the dolly, inserting the central column into the extension column and securing the rubber foot hooks onto the pedestal feet.
5. Secure the lower column lock on the extension column.

Attention

Make sure the air inlet is exposed when inserting the central column into the extension column.

